

The Grove Interpretive Center

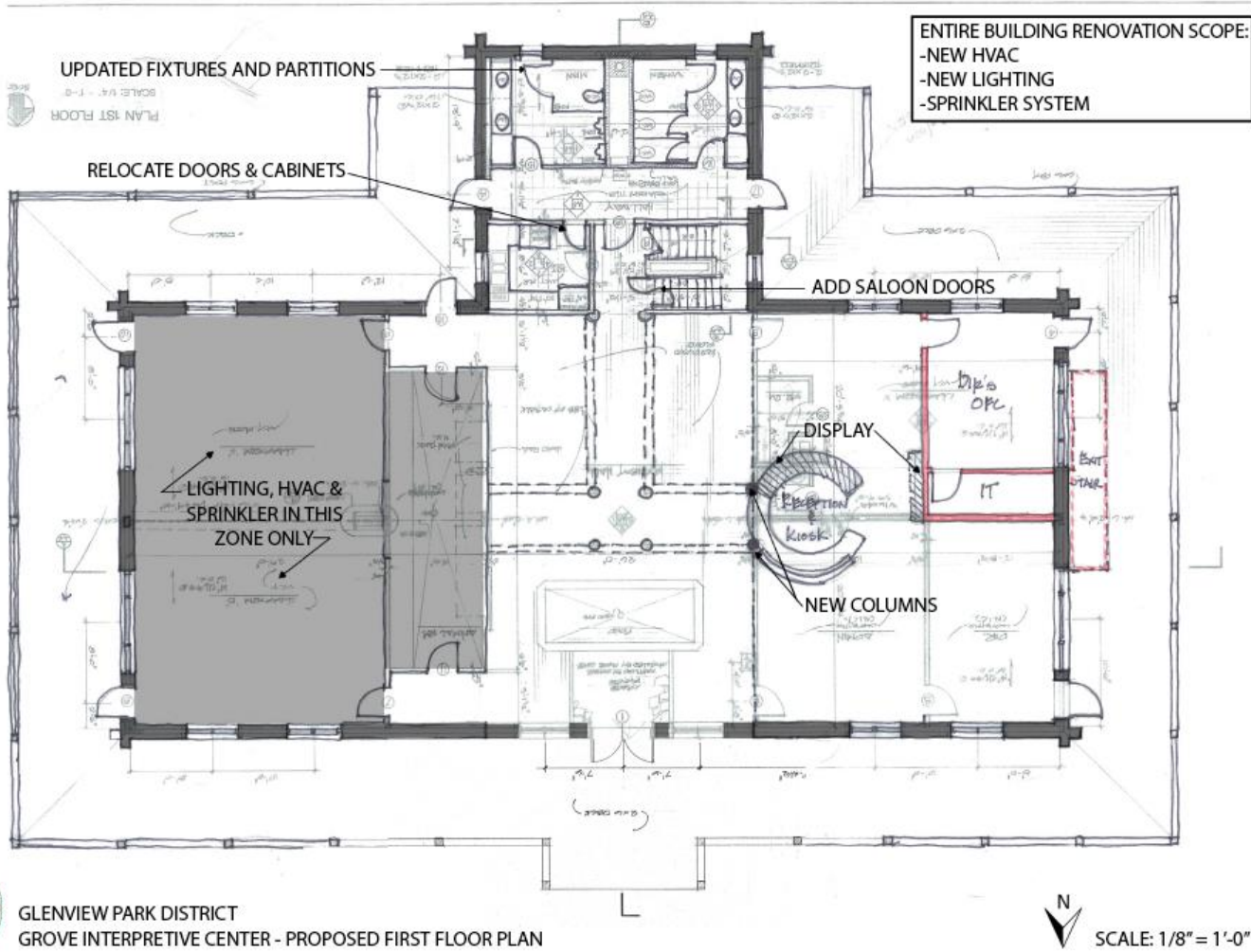

GLENVIEW PARK DISTRICT
 GROVE INTERPRETIVE CENTER - PROPOSED FIRST FLOOR PLAN



SCALE: 1/8" = 1'-0"



The Grove Interpretive Center

September 19, 2017

bluestone + associates
interpretive planning + design

Why make changes to The Grove's Interpretive Center?

- ✓ An untold story
- ✓ Connect the building, the family and the site
- ✓ Robert Kennicott
 - ✓ a passionate, accomplished and recognized naturalist
 - ✓ observed and collected on The Grove
 - ✓ on staff of Smithsonian; founder of Chicago Academy of Sciences
 - ✓ Robert died at 30 on the banks of the Yukon River in what is now Alaska
- ✓ A story waiting to be told



The Grove Interpretive Center

How can we improve the experience of the visitors to the Interpretive Center

- ✓ Let Robert be your guide through the building
- ✓ Convey his passion
- ✓ Tell stories about the natural world
- ✓ Respect the personality of the building and its exhibits
- ✓ Create some interactive experiences
- ✓ Involve all the senses: magnification, sound, touch, smell
- ✓ Create “community exhibits”
- ✓ Create “bi-level exhibits”
- ✓ Tell good stories in a conversational dialog
- ✓ Living interpreters
- ✓ Unique three part building : museum, nature center, science center



The Grove Interpretive Center

CONCEPT PLAN FOR NEW EXHIBITS AT THE GROVE

SEPTEMBER 19, 2017



bluestone + associates
interpretive planning + design

